

# 24V Constant Voltage Drivers

Installation instructions

## Warnings & Cautions

- To avoid electric shock, serious injury or property damage, isolate power before installing, removing or servicing the product
- It is recommended that these products are installed by a qualified electrician and the installation complies with the local current wiring regulations
- It may be necessary to upgrade your MCBs to allow for increased inrush current
- Any broken or damaged parts should be replaced as soon as possible. JCC will not accept responsibility for claims arising from sub-standard installations; which will void the warranty
- These products are suitable for indoor use only
- These products are designed for connection to a 220-240V~ 50/60Hz supply

## INSTALLATION

ENGLISH

Specifications: Class II 

Code	Input Voltage/Hz	Dimmable	Wattage	IP Rating	Max Output Wattage	Nominal Power Range(W)	No load Power(W) $P_{no}$	Standby Power(W) $P_{sb}$	Output Voltage	Rated efficiency @ full load
BC020009	220-240V~50/60Hz	No	12	IP20	12W	0-12W	0.5W	0.0W	24V constant Voltage	82%
BC020010	220-240V~50/60Hz	Yes, Triac	25	IP20	25W	2.4-25W	1.0W	0.0W	24V constant Voltage	84%
BC020011	220-240V~50/60Hz	Yes, Triac	50	IP20	50W	12-50W	1.0W	0.0W	24V constant Voltage	85%
BC020012	220-240V~50/60Hz	No	30	IP20	30W	0-30W	0.5W	0.0W	24V constant Voltage	85%
BC020013	220-240V~50/60Hz	No	75	IP20	75W	0-75W	0.5W	0.0W	24V constant Voltage	88%
BC020014	220-240V~50/60Hz	No	150	IP20	150W	0-150W	0.5W	0.0W	24V constant Voltage	90%
BC020015	220-240V~50/60Hz	No	240	IP20	240W	0-240W	0.5W	0.0W	24V constant Voltage	92%

Fig.1.  
Mains input

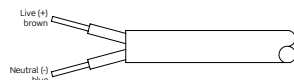

Fig.2.  
LV output



- Remove the cover(s) and connect the mains supply as per Fig.1. These products are Class II (double insulated and do not require and earth connection)
- Connect the product to the LV output from the driver as per Fig.2. and refit cover(s)
- Test for correct operation

**These products are only for use with Low Voltage 24V constant Voltage LED light sources.**

# 24V Constant Voltage Drivers

Installation instructions



## Profile & Dimensions

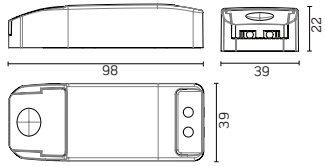

12W

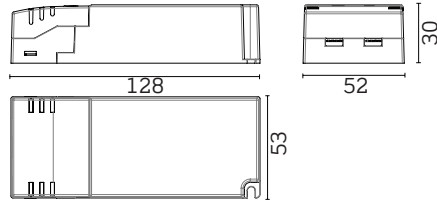

25W

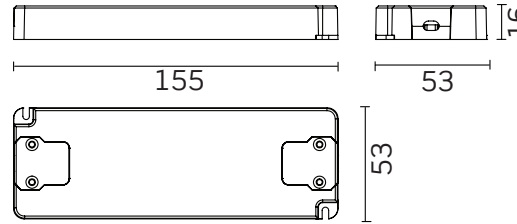

30W

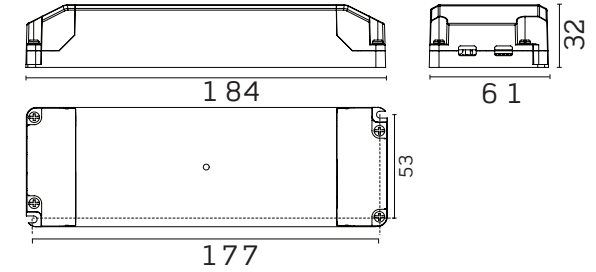

50W

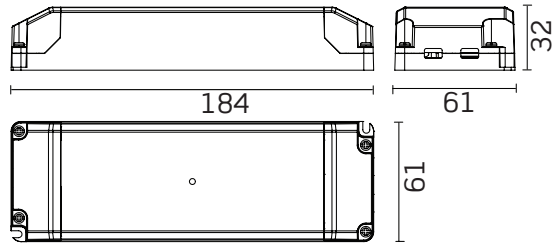

75W

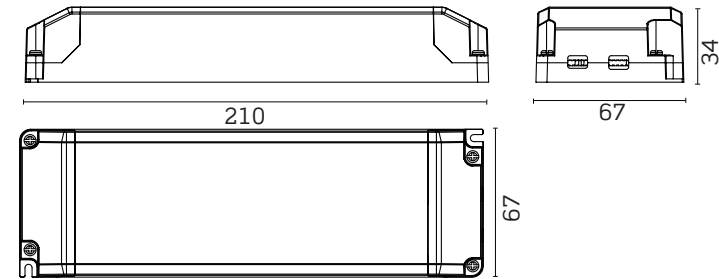

150W

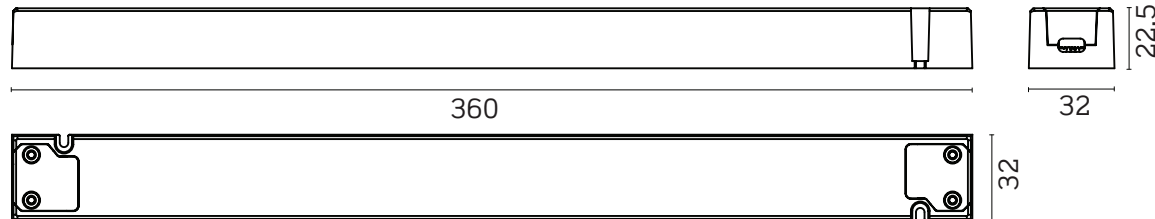

240W